

- Operate Time..... $\leq 25\text{ms}$
- Release Time..... $\leq 25\text{ms}$
- Initial Dielectric Strength
 -50/60Hz 500VAC 1 min. (between open contacts)
 -50/60Hz 1500VAC 1 min. (between contacts and coil)
 -50/60Hz 1500VAC 1 min. (between contact sets)
- Vibration Resistance
 -Malfunction: 10 to 55Hz at Double Amplitude of 1.5mm
 -Destructive: 10 to 55Hz at Double Amplitude of 1.5mm
- Shock Resistance
 -Malfunction: 10G (11ms) / Destructive: 100G (6ms)
- Ambient Temperature..... $-25^{\circ}\text{C} \sim +55^{\circ}\text{C}$
- Relative Humidity..... 85% at 40°C
- Unit Weight.....Approx. 35g

ORDERING INFORMATION

951-1C -12 D P M L -G- F
 1 2 3 4 5 6 7 8 9

Type of Insulation..... Nil = Class A
F = Class F

Contact Material..... Nil = General Type
G = Contact with Gold Plating

Optional..... Nil = General Type
L = With Lamp and Diode (DC Coil Type Only)
N = With Lamp
B = With Push Button
T = With Lamp and Push Button
K = With Lamp and Diode and Push Button
 (DC Coil Type Only)

Cover Type..... Nil = General Type
M = Flange Top Type
S = Special Type
E = Special Flange Top Type

Terminal Type..... Nil = Socket Terminal
P = P.C.B. Terminal

Coil Type.....D: DC
A: AC

Coil Voltage..... DC: 6~100V
 AC: 12~270V

Contact Arrangement.....1A = 1 Form A (SPST-NO)
1B = 1 Form B (SPST-NC)
1C = 1 Form C (SPDT)
2C = 2 Form C (DPDT)

Model Number.....951

COIL RATINGS (at 20°C)

COIL TYPE	Coil Nominal Voltage (V)	Coil Resistance ($\Omega \pm 10\%$)	Pick-Up Voltage (V) \leq	Drop-Out Voltage (V) \geq	Nominal Current (mA)
DC Standard Coils	6	40	4.5	0.6	150
	12	160	9	1.2	75
	24	650	18	2.4	37
	48	2600	36	4.8	19
	100	11000	75	10	9
AC	12	46	9	3.6	
	24	180	18	7.2	
	110	3750	82.5	33	
	120	4430	90	36	
	220	12950	165	66	
	240	18790	180	72	
	270	24150	202.5	81	

* Max Continuous Voltage at 20°C: 110% of Coil Nominal Voltage.

OUTLINE DIMENSIONS

Dimensions

Internal Connections (Bottom View)

Drilling Plan (Bottom View)

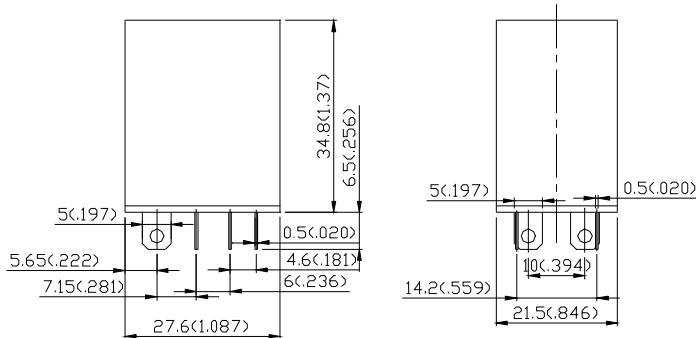

General Type

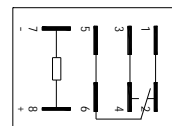

1 Form C

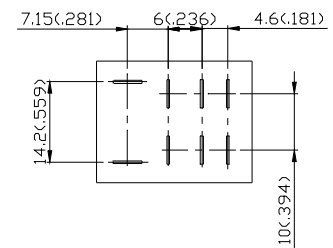

General Type

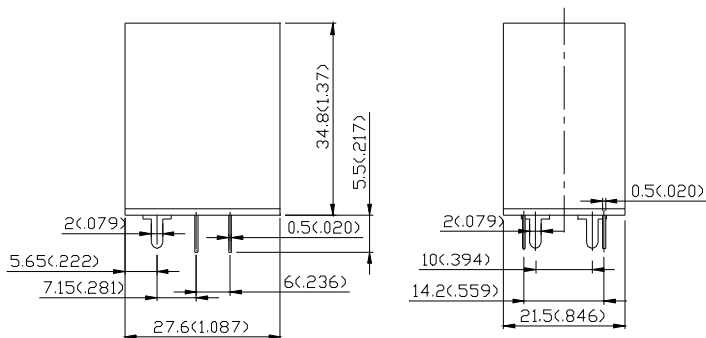

P.C.B Type

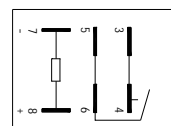

1 Form A

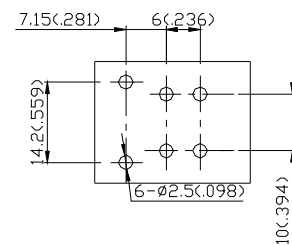

P.C.B Type

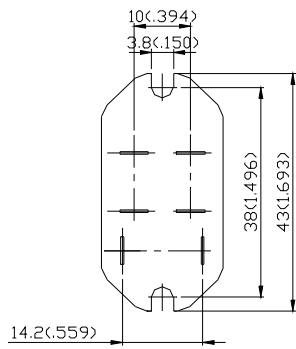

Outline Connect Type

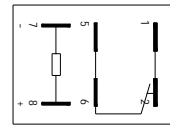
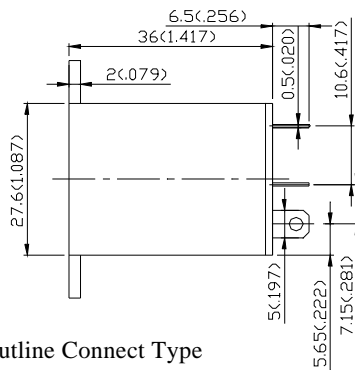

1 Form B

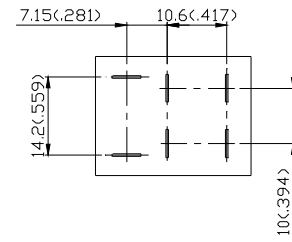

Outline Connect Type

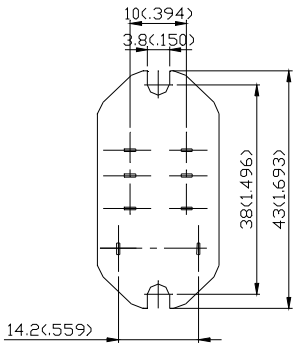

Outline Connect P.C.B Type

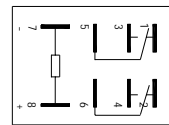
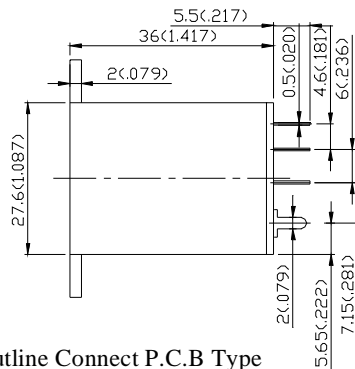

2 Form C

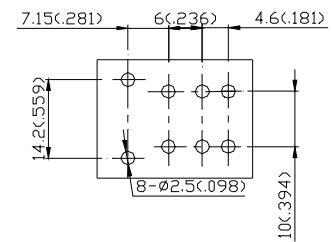

Outline Connect P.C.B Type

REMARK: 1.Tolerance of outline dimensions: $\pm 0.2(.008)$.

2.The polarity of coil is only applied for DL, DN, DPL and DPN type.

UNIT: mm (inch)