

948 Series Relay

FEATURES

- UL & CQC safety approval.
- Heavy-duty 20A miniature high power relay.
- Surge strength: 4500 VAC.
- 1 form A (SPST) contact.
- Standard power consumption in small package.
- Nominal power 900mW.
- Operating power 510mW.
- P.C.B. terminal & quick connect terminal.
- Washable type.

CONTACT RATINGS

- Contact Arrangement.....1 Form A (SPST-NO)
- Max. Switching Power.....5000VA
- Max. Switching Voltage.....250VAC
- Max. Switching Current.....20A
- Contact Resistance..... $\leq 100m\Omega$
- Resistive Load.....20A/250VAC
- Inductive Load(Cos $\phi=0.4$)15A/250VAC
- Contact Material..... Ag Alloy

CHARACTERISTICS

- Electrical Life..... 1×10^5
- Mechanical Life 2×10^6
- Initial Insulation Resistance.....Min. 1000M Ω 500VDC
- Contact Resistance (Initial)..... $\leq 100m\Omega$
- Operate Time..... $\leq 20ms$
- Release Time..... $\leq 10ms$
- Initial Dielectric Strength
 -50/60Hz 1000VAC 1 min. (between open contacts)
 -50/60Hz 4500VAC 1 min. (between contacts and coil)
- Vibration Resistance
 -Malfunction: 10 to 55Hz at Double Amplitude of 1.5mm
 -Destructive: 10 to 55Hz at Double Amplitude of 1.5mm
- Shock Resistance
 -Malfunction: 10G (11ms) / Destructive: 100G (6ms)
- Ambient Temperature..... $-25^{\circ}C \sim +55^{\circ}C$
- Relative Humidity.....85% at $40^{\circ}C$
- Unit Weight.....Approx. 22g



UL FILE NO: E169563

CQC FILE NO: CQC02001001779

948 Referential Data Timing

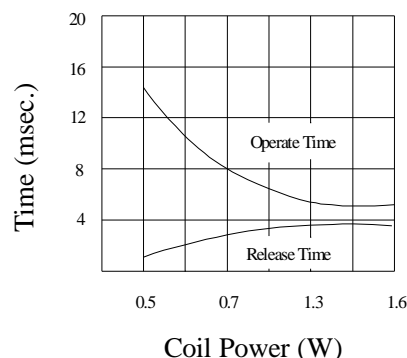

Coil Temperature Rise

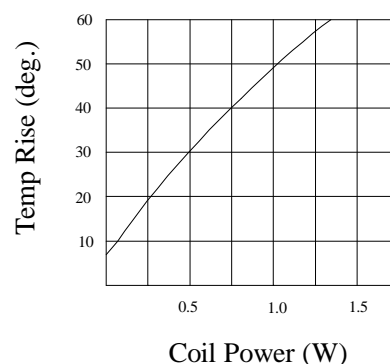

Life Curves

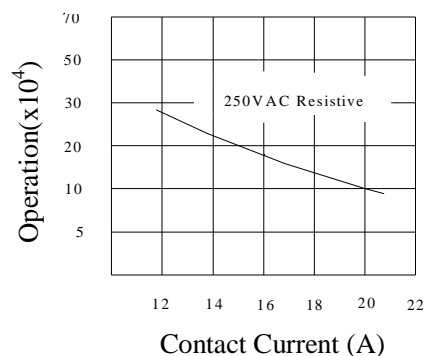

ORDERING INFORMATION

948 - 1A - 6 D P
 1 2 3 4 5

Terminal Form.....Nil = General Type

Top: Tab Terminal
 Bottom: PCB Terminal

.....P = Bottom P.C.B. Terminal Only

Coil Type..... D: DC

Coil Voltage..... 5~24V

Contact Arrangement

.....1A = 1 Form A (SPST-NO)

Model Number.....948

COIL RATINGS (at 20°C)

COIL TYPE	Coil Nominal Voltage (V)	Coil Resistance ($\Omega \pm 10\%$)	Pick-Up Voltage (V) \leq	Drop-Out Voltage (V) \geq	Nominal Current (mA)
DC Standard Coils	5	27.7	3.75	0.5	180
	6	40	4.5	0.6	150
	9	90	6.75	0.9	100
	12	160	9	1.2	75
	18	360	13.5	1.8	50
	24	640	18	2.4	37.5

* Max Continuous Voltage at 20°C: 110% of Coil Nominal Voltage.

OUTLINE DIMENSIONS

Dimensions

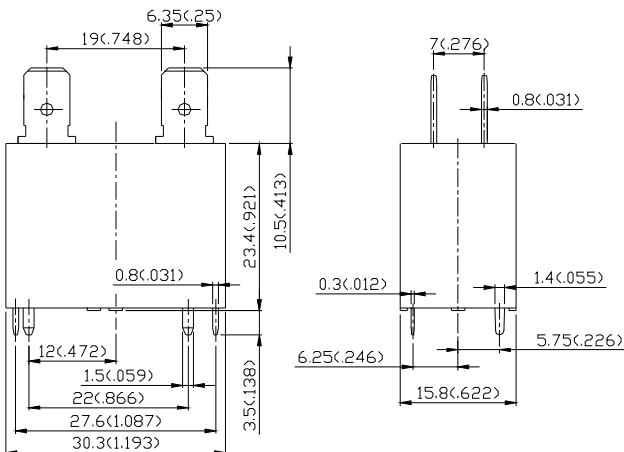

Internal Connections
(Bottom View)

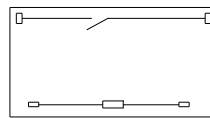

Drilling Plan
(Bottom View)

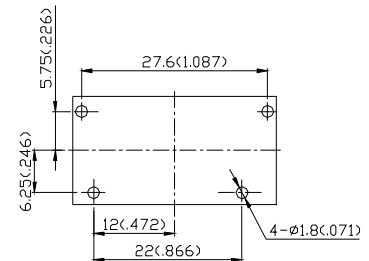

REMARK: Tolerance of outline dimensions: $\pm 0.2(.008)$.

UNIT: mm (inch)