

Coil Specification (at 20°C)

Coil Sensitivity	Nominal Voltage (VDC)	Nominal Current (mA)	Coil Resistance ($\Omega \pm 10\%$)	Power Consumption (W)	Pull-In Voltage (VDC)	Drop-Out Voltage (VDC)	Maximum Allowable Voltage (VDC)
GSR-H/F	3	47.6	63	Abt. 0.1 to 0.28	70% Maximum	10% Minimum	160%
	5	20.0	250				
	6	24.0	250				
	8	11.4	700				
	9	12.9	700				
	12	11.4	1,050				
	24	11.5	2,080				

Ordering Information

GSR - C - 1 12 H	Coil Current:	H: 0.5A F: 1A
	Coil Voltage:	03: 3V, 05: 5V, 06: 6V, 08: 8V, 09: 9V, 12: 12V, 24: 24V
	Number of Pole:	1: One Pole
	Type of Case:	Nil: Open Type M: With Metal Case C: With Plastic Case
	Type:	GSR

Classification

Model	GSR	
Contact Capacity	H : 0.5A	F : 1A
Open Type	GSR-1□□H	GSR-1□□F
With Metal Case	GSR-M-1□□H	GSR-M-1□□F
With Plastic Case	GSR-C-1□□H	GSR-C-1□□F

Dimension

GSR-1a / GSR-1b

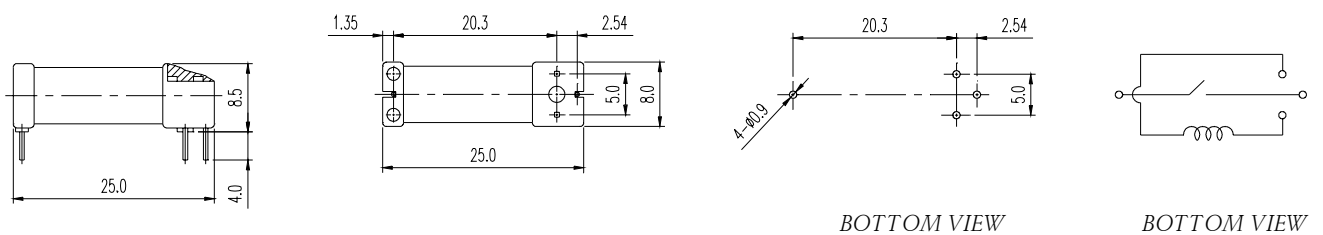

GSR-C-1a / GSR-M-1b

GSR-M-1a / GSR-M-1b

